

Erosion and Sediment Control Inspection Report

General Information		
Project Name	Goodwin Industry 5.0 High School	Approximate Acreage: 12
Owner/Permittee	Goodwin University	
Watershed Management Permit No.:		
Site Location	2 & 3 Pent Road, East Hartford, CT	
Date of Site Visit	May 10, 2025	NPDES Permit No. (if applicable): ILR
Observer's Name & Title	John Martz, Project Engineer	
Enforcement Officer		
Stage of Construction	Phase I	Photos Taken <input checked="" type="checkbox"/> Yes <input type="checkbox"/> No
Type of Site Visit:		
<input checked="" type="checkbox"/> Routine <input checked="" type="checkbox"/> Post-Storm Event <input type="checkbox"/> Other: _____		
Weather Information		
Weather Conditions: Sunny, 68 degrees		
Estimated end date of most recent $\geq 0.5''$ rain event: May 9, 2025		
Site Observations – Describe Location and Recommend Corrective Measures on Back Page		

No.	BMP/Activity	Implemented & Maintained
1	Are discharge points and receiving waters free of sediment deposits and other pollutants?	<input checked="" type="checkbox"/> Yes <input type="checkbox"/> Action Item <input type="checkbox"/> N/A
2	Have BMPs specified in the SWPPP been installed and maintained?	<input type="checkbox"/> Yes <input checked="" type="checkbox"/> Action Item <input type="checkbox"/> N/A
3	Has the SWPPP been updated to reflect the current conditions on site?	<input checked="" type="checkbox"/> Yes <input type="checkbox"/> Action Item <input type="checkbox"/> N/A
4	Are outlets protected/stabilized?	<input checked="" type="checkbox"/> Yes <input type="checkbox"/> Action Item <input type="checkbox"/> N/A
5	Have stormwater management systems been constructed, stabilized, and verified to be functioning appropriately?	<input checked="" type="checkbox"/> Yes <input type="checkbox"/> Action Item <input type="checkbox"/> N/A
6	Are Special Management Areas (e.g., creeks, wetlands, buffers, etc.) adequately protected?	<input type="checkbox"/> Yes <input type="checkbox"/> Action Item <input checked="" type="checkbox"/> N/A
7	Are storm drain inlets adequately protected?	<input type="checkbox"/> Yes <input checked="" type="checkbox"/> Action Item <input type="checkbox"/> N/A
8	Have all idle, disturbed areas been temporarily stabilized?	<input checked="" type="checkbox"/> Yes <input type="checkbox"/> Action Item <input type="checkbox"/> N/A
9	Are erodible stockpiles (e.g., topsoil) properly located and adequately protected?	<input type="checkbox"/> Yes <input checked="" type="checkbox"/> Action Item <input type="checkbox"/> N/A
10	Are washout facilities (e.g., concrete washouts, etc.) available and maintained?	<input type="checkbox"/> Yes <input type="checkbox"/> Action Item <input checked="" type="checkbox"/> N/A
11	Is waste, including building materials and construction debris, collected and placed in approved receptacles?	<input checked="" type="checkbox"/> Yes <input type="checkbox"/> Action Item <input type="checkbox"/> N/A
12	Are non-stormwater discharges (e.g., dewatering) properly controlled?	<input type="checkbox"/> Yes <input type="checkbox"/> Action Item <input checked="" type="checkbox"/> N/A
13	Are vehicle and equipment fueling, cleaning, and maintenance areas free of spills, leaks, or any other potential pollutants?	<input checked="" type="checkbox"/> Yes <input type="checkbox"/> Action Item <input type="checkbox"/> N/A
14	Are portable toilets, material storage areas, and materials that are potential stormwater contaminants managed appropriately?	<input checked="" type="checkbox"/> Yes <input type="checkbox"/> Action Item <input type="checkbox"/> N/A
15	Are stabilized entrances installed and are adjacent roads clear of sediment?	<input checked="" type="checkbox"/> Yes <input type="checkbox"/> Action Item <input type="checkbox"/> N/A
16	Other, based on site conditions:	<input type="checkbox"/> Yes <input type="checkbox"/> Action Item <input checked="" type="checkbox"/> N/A

No.	Location and Recommended Corrective Measure	Completed/Initial
1	2 Pent Road - install E&S control measures around the topsoil stockpile - E&S control measures in	<input type="checkbox"/>
	downstream CBs effectively functioning	<input type="checkbox"/>
2	2 Pent Road - ensure that silt fence is trenched-in throughout the site, so no sediment can go under fence	<input type="checkbox"/>
	or between stakes	<input type="checkbox"/>
3	3 Pent Road - replace silt fence stake on east side of soil stockpile that is leaning at ~ 45 degree angle	<input type="checkbox"/>
	and where soil stockpile material is built up against silt fence	<input type="checkbox"/>
4	2 Pent Road - standing water observed in driveway surrounding easternmost CB - remove sediment	<input type="checkbox"/>
	& clean CB for proper function	<input type="checkbox"/>
5	3 Pent Road - Stabilize disturbed areas if no additional grading is to be performed	<input type="checkbox"/>
		<input type="checkbox"/>
		<input type="checkbox"/>
		<input type="checkbox"/>
		<input type="checkbox"/>
		<input type="checkbox"/>
		<input type="checkbox"/>
		<input type="checkbox"/>
		<input type="checkbox"/>
		<input type="checkbox"/>
		<input type="checkbox"/>

General Comments:

- No construction activities taking place at time of inspection
- General Comment: Monitor and clean out silt sacks in catch basins when they have collected 6"-12" of sediment to ensure proper function

Certification Statement: *(To address NPDES Permit No. ILR10 requirements)*

"I certify under penalty of law that this document and all attachments were prepared under my direction or supervision in accordance with a system designed to assure that qualified personnel properly gathered and evaluated the information submitted. Based on my inquiry of the person or persons who manage the system, or those persons directly responsible for gathering the information, the information submitted is, to the best of my knowledge and belief, true, accurate, and complete. I am aware that there are significant penalties for submitting false information, including the possibility of fine and imprisonment for knowing violations."

Print Name & Title: Judy Ascano Schuler, P.E., Principal Engineer

Signature:  Date: 05/13/2025

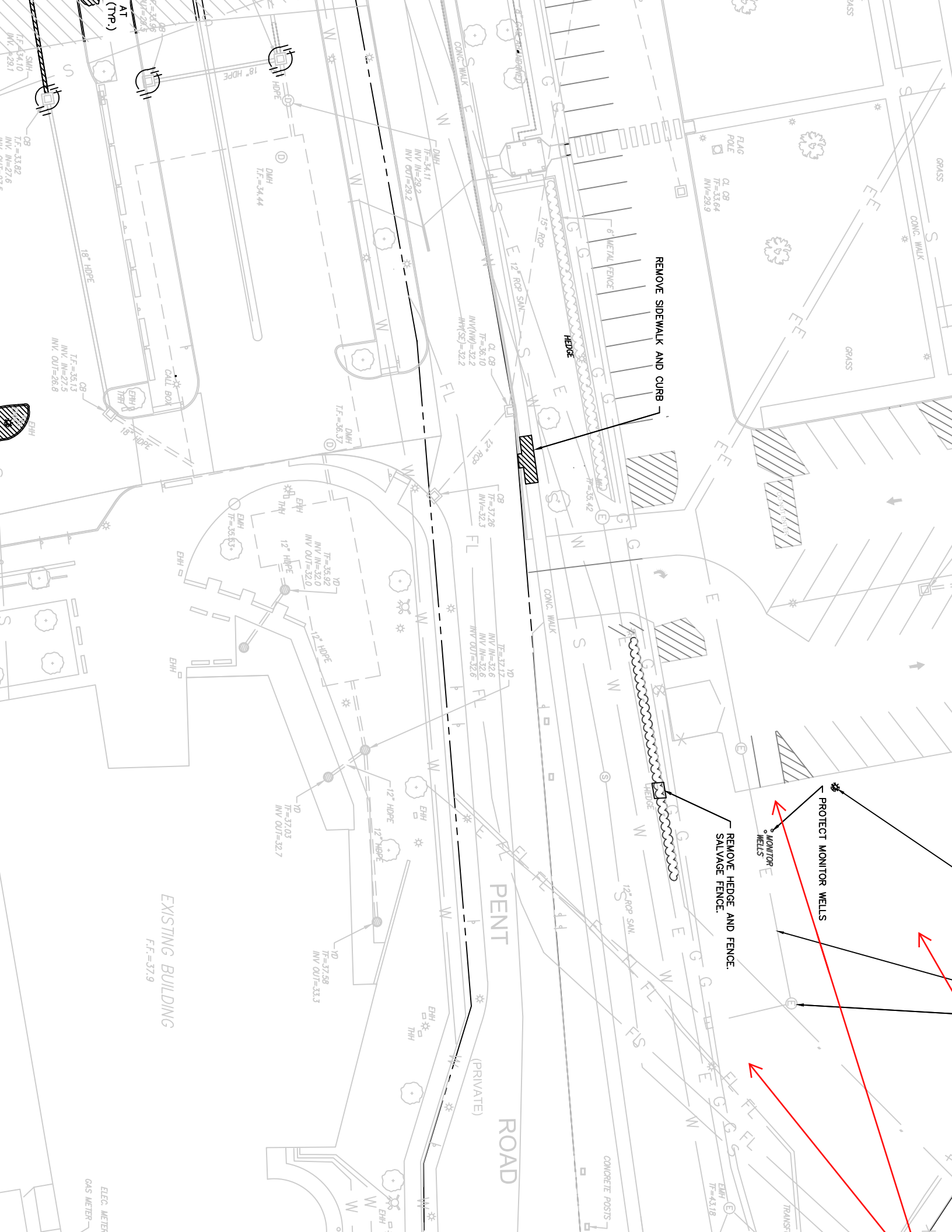



Picture 1: Silt Fence post down around stockpile area.



Picture 2 & 3: Seed and stabilize bare earth areas.



Picture 3 & 4: Remove debris and standing water in catch basins.



Picture 5: Silt fence not buried.